

GENERAL/OVERVIEW WIRING SCHEMATIC

MMI<->IOBOARD<->PQ AMPLIFIER<->SMPS<->FILTER

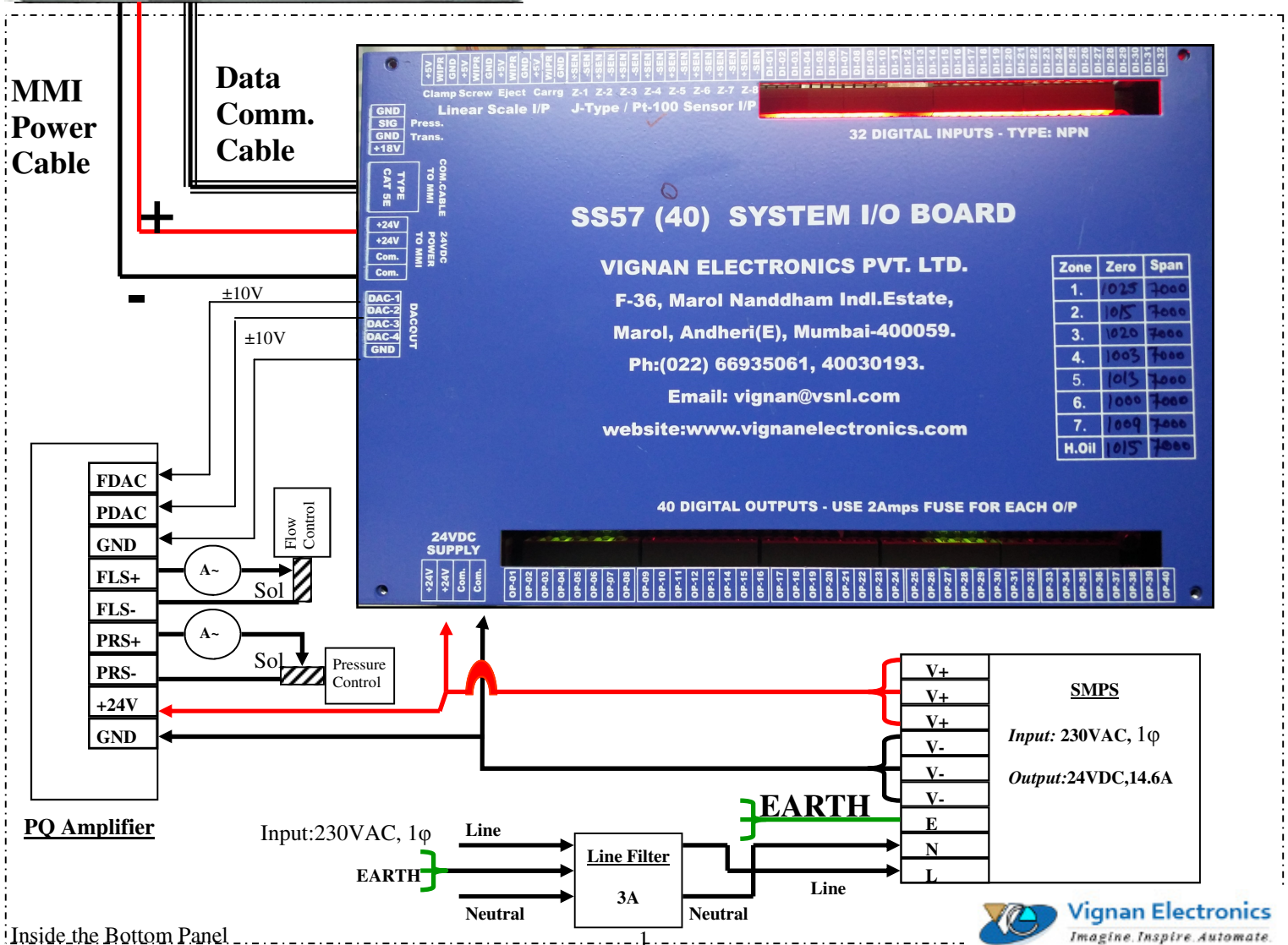

USB Comm.Cable



Inside the Bottom Panel

COMMON/RETURN WIRE FROM LSW/SENSORS/MODULES SHOULD BE CONNECTED TO DIGITAL INPUTS

DIGITAL INPUT	CONNECTION TO
DI-01 (LSW01)	TRANSFERABLE
DI-02 (LSW02)	MOLD LOCKING CONFIRMATION
DI-03 (LSW03)	EJECTOR FORWARD POSITION
DI-04 (LSW04)	EJECTOR RETRACT POSITION
DI-05 (LSW05)	CARRIAGE FORWARD POSITION
DI-06 (LSW06)	CARRIAGE RETRACT POSITION
DI-07 (LSW07)	ROBO READY INPUT /ACCUMULATOR LP SWITCH
DI-08 (LSW08)	ROBO CYC.COMPLETE/ACCUMULATOR HP SWITCH
DI-09 (LSW09)	FRONT SAFETY GUARD OPEN
DI-10 (LSW10)	FRONT SAFETY GUARD CLOSE
DI-11 (LSW11)	REAR SAFETY GUARD CLOSE
DI-12 (LSW12)	NOZZLE SAFETY GUARD CLOSE
DI-13 (LSW13)	MINIMUM MOULD HEIGHT SAFETY
DI-14 (LSW14)	DIE HEIGHT PULSE DETECTOR
DI-15 (LSW15)	MOULD HEIGHT FORWARD
DI-16 (LSW16)	MOULD HEIGHT RETRACT
DI-17 (LSW17)	CORE-1 IN
DI-18 (LSW18)	CORE-1 OUT
DI-19 (LSW19)	CORE-2 IN
DI-20 (LSW20)	CORE-2 OUT
DI-21 (LSW21)	CORE-3 IN
DI-22 (LSW22)	CORE-3 OUT
DI-23 (LSW23)	CORE-4 IN
DI-24 (LSW24)	CORE-4 OUT
DI-25 (LSW25)	HYDRAULIC OR LUB OIL LEVEL LOW
DI-26 (LSW26)	LUBRICATION OIL PRESSURE SWITCH
DI-27 (LSW27)	DROP DETECT SENSOR
DI-28 (LSW28)	ENERGY METER PULSE INPUT
DI-29 (LSW29)	HOPPER EMPTY
DI-30 (LSW30)	SCREW SPEED PROXY SENSOR
DI-31 (LSW31)	HYDRAULIC MOTOR ON INPUT
DI-32 (LSW32)	EMERGENCY PB INPUT(NC)

32 DIGITAL INPUTS :TYPE NPN
DIGITAL INPUTS (1-32) WIRING SCHEMATIC

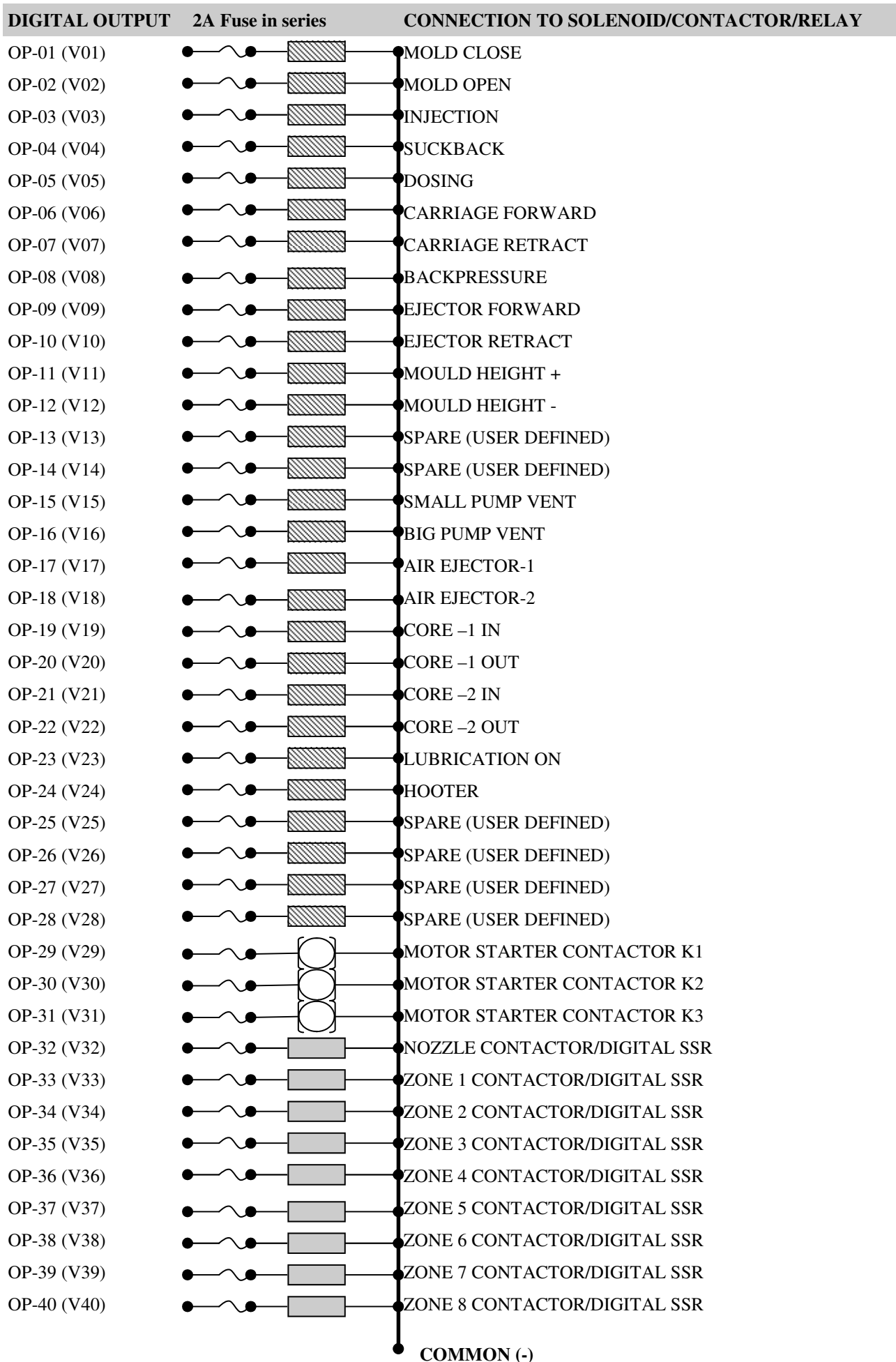
**DIGITAL OUTPUTS (1-40) WIRING SCHEMATIC**



DAC OUTPUT (-10 TO +10VDC)	CONNECTION TO
DAC-1 →	FLOW CONTROL ELEMENT (DEFAULT)
DAC-2 →	PRESSURE CONTROL ELEMENT (DEFAULT)
DAC-3 →	FLOW CONTROL ELEMENT (DEFAULT)
DAC-4 →	PRESSURE CONTROL ELEMENT (DEFAULT)
GND →	TO COMMON OF AMPLIFIER CARD/SERVO DRIVE/AC DRIVE

> For Backpressure proportional valve connect DAC-3/4 output to an *extra amplifier card* & set the **Auto Solenoid energization tables on MMI accordingly.**

AMPLIFIER CARD NOTES:

BY DEFAULT AMPLIFIER CARD DRIVES VALVE SOLENOIDS RATED UPTO 24VDC,1.6A

ANY ABOVE VOLTAGE REQUIREMENTS >24VDC, RECONNECT JUMPERS J1,J2 TO HV.

ANY ABOVE CURRENT REQUIREMENTS>1.6A, REPLACE 20E RESISTORS

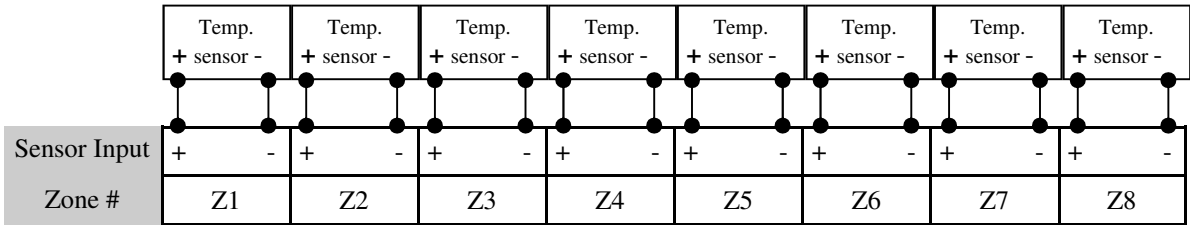

Temperature Sensor= J-type Thermocouple (Isolated)/ Pt-100 RTD

Temperature Sensor Wiring Schematic

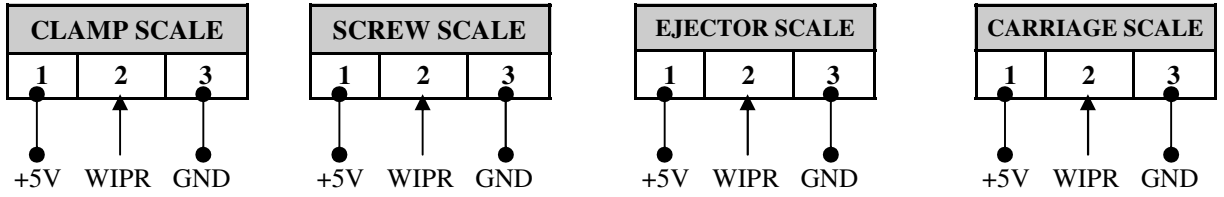

Linear Potentiometers/Scales Wiring Schematic

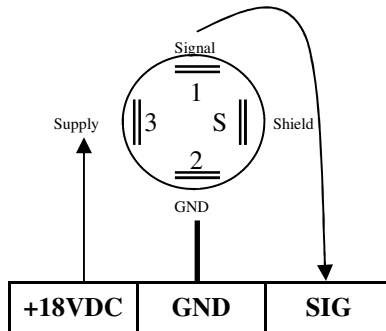

Pressure Transducer Input Wiring Schematic

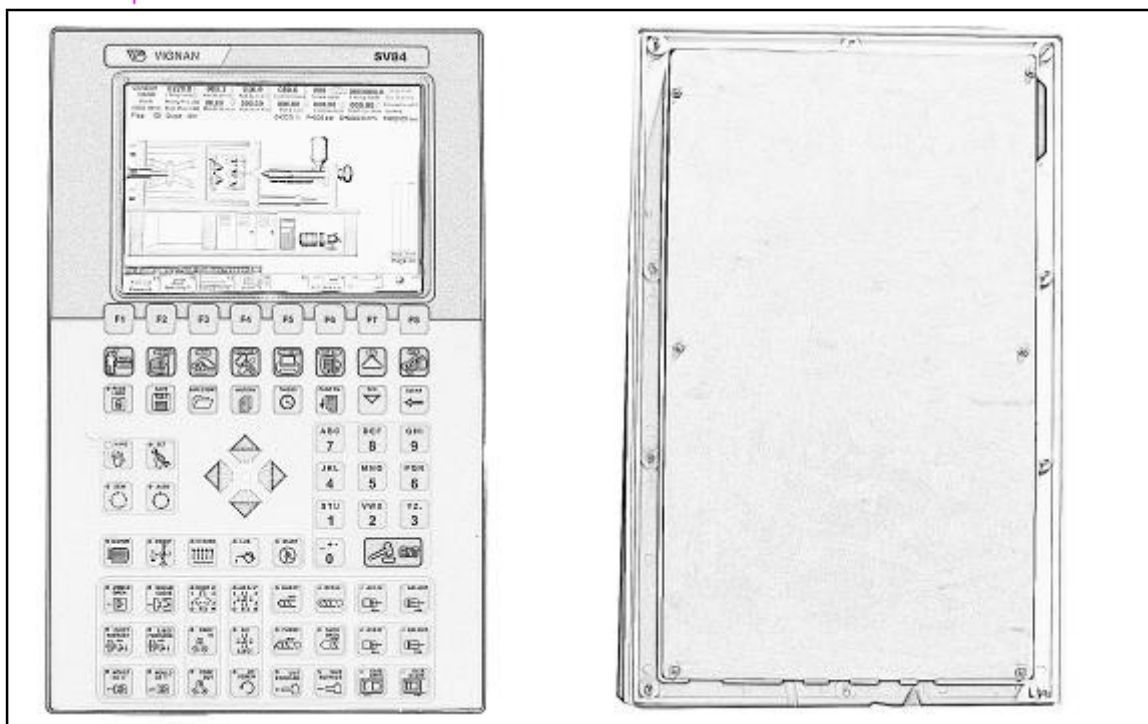
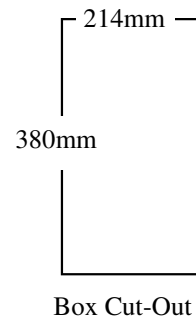
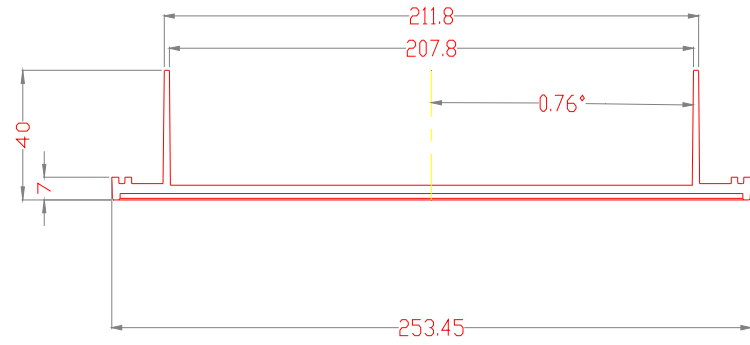
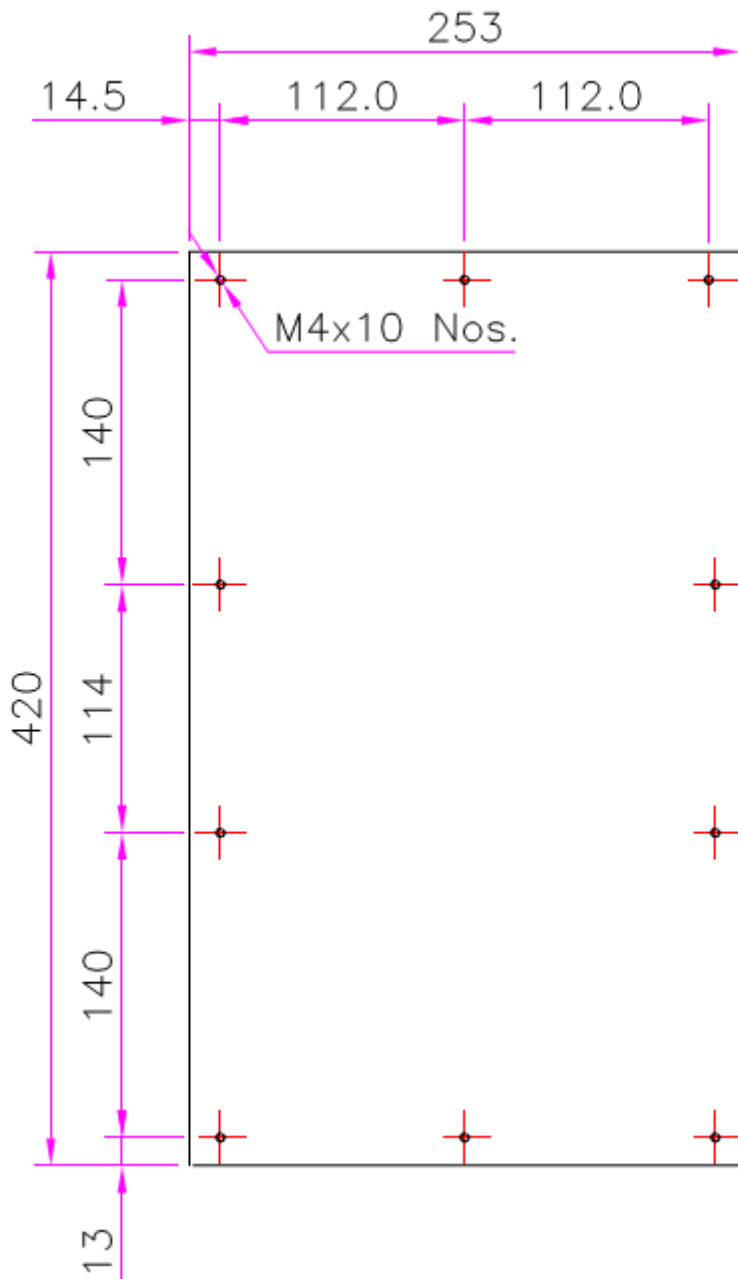

Mechanical Dimensions for Frame Fabrication